

Quality

- ISO 9001 Certified Company
- Company and Product Certified and Qualified CRCC Petrobras

Principais Características

- Operation: On/Off
- Construction: MSS-SP 81
- Type: Wafer and Semi LUG
- Size: 2" (50mm) to 16" (400mm)
- Flow: Unidirectional
- 100% Tightness
- High performance with full pass

Aplicação Geral

- Paper and Pulp, Chemical, Petrochemical, Sugar, Alcohol, etc.
- Liquids in general, doughy, pastes and the like.

Maximum pressure (Temperature between 0°C to 30°C)

DN	Pol.	2"	2. 1/2"	3"	4"	5"	6"	8"	10"	12"	14"	16"
	mm	50	65	80	100	125	150	200	250	300	350	400
	CWP(bar)	10	10	10	10	10	10	10	10	7	7	7

Maximum Temperature

EPDM (°C)	PTFE (°C)
-10 a 110	4 a 180

Internal Testing and Inspection

Hydrostatic: ISO 5208 / EN 12266 / MSS SP 151

Performance: 1 (one) Complete Cycle (Open and Close)

Painting: NBR 14847

Visual: NBR 15185

Fixation: NBR 7675 / EN 1092 / ANSI B16.5 / ANSI B16.47

Dimensional: Approved Drawing / EN 558 / MSS SP81

Flange / Connection

- ANSI B16.5 - 150lbs
- Others on request

Types of Drives

- Hand wheel
- Pneumatic Actuator

Optional Accessories

- Solenoid valve
- End of Course Key
- Lubrifil kit
- Others

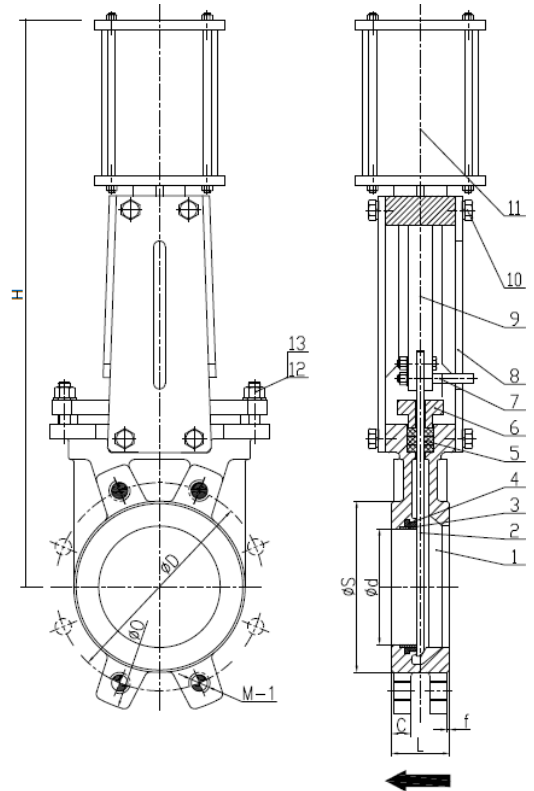

**PRODUCT
READY DELIVERY**

Stock subject to change without notice

Material Table

Pos.	Description	Material
1	Body	GGG40 / ASTM A351 CF8 / ASTM A351 CF8M
2	Gate/ Knife	AISI 304 / AISI 316
3	Retainer Ring	AISI 304 / AISI 316
4	Facial Sealing	PTFE / EPDM
5	Superior Sealing	Synthetic Fiber with PTFE+ Silicone Cord
6	Preme	ASTM A216 GR WCB / ASTM A351 CF8 / ASTM A351 CF8M
7	Position Indicator	AISI 420
8	Support/ Yoke	ASTM A36
9	Stem	AISI 304
10	Prisoners Support	Carbon Steel
11	Drive	Manual or Automatic
12	Preme Prisoner	Carbon Steel or Stainless Steel
13	Preme Nut	Carbon Steel or Stainless Steel

(*) other options on request

Dimensions Table

				ANSI B16.5 150 lbs		
DN	H (*)	L	ØDo	ØD	ØE	
In.	mm	mm	mm	Nº - M-1	In.	
2"	50	430	48	180	04 - 3/8" UNC	4. 3/4"
2. 1/2"	65	460	48	180	04 - 3/8" UNC	5. 1/2"
3"	80	510	51	200	04 - 3/8" UNC	6"
4"	100	570	51	200	08 - 1/2" UNC	7. 1/2"
5"	125	660	57	220	08 - 3/4" UNC	8. 1/2"
6"	150	720	67	250	08 - 3/4" UNC	9. 1/2"
8"	200	890	70	300	08 - 3/4" UNC	11. 3/4"
10"	250	1.120	70	350	12 - 1/2" UNC	14. 3/4"
12"	300	1.230	70	350	12 - 1/2" UNC	17"
14"	350	1.370	76	400	12 - 1" UNC	18. 3/4"
16"	400	1.570	89	500	16 - 1" UNC	21. 1/4"

Notes:

1. (*) Measure "H" under consultation for other types of drives;
2. Measures subject to change without notice.